

blaugelb Knob Handle Set ZT/KGT FS U Shape PZ Class 4

Tested safety for fire, smoke and escape doors in the property sector.

- High-quality materials and steel substructures
- Tested in accordance with DIN 18273, DIN EN 179 and DIN EN 1906
- Maintenance-free plain bearing and holding springs for precise positioning
- Elegant appearance on the door
- Concealed screws

Product features:

The blaugelb Knob Handle Set ZT/KGT FS U Shape PZ Class 4 is suitable for fire, smoke and escape doors with increased safety requirements in terms of fire protection in accordance with DIN 18273, for emergency escape locks in accordance with DIN EN 179 and for the property sector in accordance with DIN EN 1906 and has been tested accordingly. The supplied key rosettes (PZ), like the lever handle rosettes, also have positioning studs to ensure precise and permanent positioning on the door.

The set has maintenance-free plain bearings and a removable handle connection with ball lock. The used holding springs guarantee exact positioning of the lever handle.

The attractive, elegant Knob Handle Set ZT/KGT FS U Shape PZ Class 4 is available in fine matt stainless steel. The set is mounted by means of concealed screws (supplied).

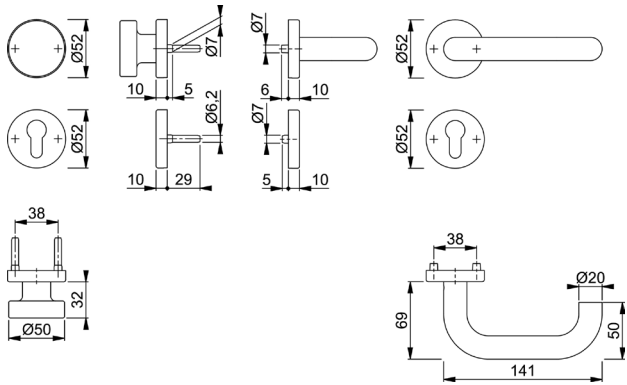

Product benefits:

- High-quality materials and steel substructures
- Tested in accordance with DIN 18273, DIN EN 179 and DIN EN 1906
- Maintenance-free plain bearing and holding springs for precise positioning
- Elegant appearance on the door
- Concealed screws

Technical data:

Material:	fine matt stainless steel
Lever mounting:	fixed on outside; fixed/pivoting on inside, ball lock with holding spring
Lever square socket:	9 mm profile full pin
Keyhole:	PZ
Classification code: DIN EN 1906	4 7 - D1 1 5 0 A
Door thickness:	40 - 65 mm
Rosette diameter:	52 mm
Rosette height:	10 mm
Fastening:	concealed screws, M4 threaded bolts
Packing unit:	1 set

Product name	PU	Item no.
blaugelb Knob Handle Set ZT/KGT FS U Shape PZ Class 4, stainless steel	1 piece	9066263